

Differential Pressure Switch

G75-DP

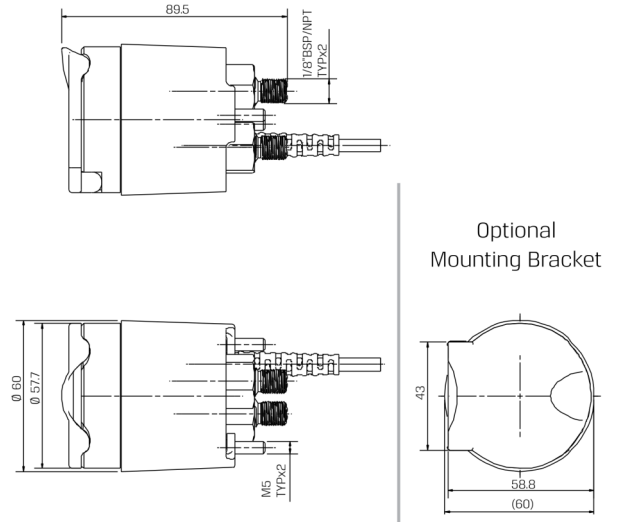
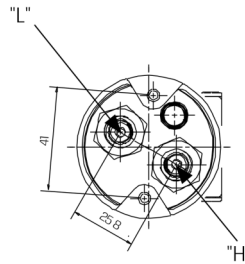

Technical Data

Mechanical	<ul style="list-style-type: none"> Operating temperature : -10°C to 60°C (no freezing) Outdoor UV protection Front panel cover protection "H" proof pressure : 14 bar (203 PSI) "H" pressure must be \geq "L" pressure.
Electrical	<ul style="list-style-type: none"> Power supply : 6-24V DC or 12-24V AC RED + BLK power supply GRN / WHT N.O contact Low power detect Dry contact (N.O) 0.5A at 24V AC Internal memory to retain "set-up data" at power down.
Mounting	<ul style="list-style-type: none"> 2" (52mm) diameter 2ft (60cm) 4 wires cable Pressure ports 1/8" BSP/NPT (male) High pressure port is marked by the letter "H" on the housing Connect high pressure before low pressure Disconnect low pressure before high pressure
Software	See 'Programming key features' table
Display	<p>The LCD display :</p> <ul style="list-style-type: none"> DIF : measured differential pressure SET : pressure differential trigger setting ON : displayed when the switch contacts are closed <p>Display resolution :</p> <p>1 PSI in the range 0 - 99 psi 0.1 bar in the range 0.0 - 7 bar.</p>
Standard protection class	<ul style="list-style-type: none"> Dust and watertight IP66

Programming key features

Manual operation
PSI or bar display
Time interval between pressure measurements
Contact closed time
Time interval between contact closure
Zero calibration

How to Order

G75-DP	-	TYPE	ACCESSORIES
		Stand alone	1
		Mounting bracket	B
		Latch solenoid driver	D

- Reads and reacts to pressure differential between two reading points
- Suitable to work with both media - air and liquid
- Main applications: filters backwash, pumps control, pressure control